

| 52634               |   | DB Schienenbus      | =                            |   |
|---------------------|---|---------------------|------------------------------|---|
| 52635               |   |                     | =                            | 🔊 |
| Pos. Nr.<br>Pos.no. | Beschreibung<br>Description   | Art.-Nr.<br>Art.no. | Preisgruppe<br>Price bracket |   |
| 1                   | Gehäuse komplett VT Betr. Nr. 798 717-5<br>Body assembly Loco no. 798 717-5 | 147552              | 32                           |   |
| 2                   | Schraube M 2x6 mm<br>Screw  | 85672               | 3                            |   |
| 3                   | Zugfeder<br>Pull spring   | 86208               | 3                            |   |
| 4                   | Schneckenzahnrad Z=16/17<br>Worm gear                                       | 86419               | 6                            |   |
| 5                   | Zahnrad Z=19/12 M 0,4<br>Gear I=19/12 M 0,4                                 | 86424               | 4                            |   |
| 6                   | Schnecksatz<br>Worm set   | 86980               | 13                           |   |
| 7                   | Kardanschale<br>Cardan bearing  | 87152               | 3                            |   |
| 8                   | Kardanwelle<br>Cardan shaft   | 87211               | 5                            |   |
| 9                   | Puffer flach<br>Buffer flat   | 88581               | 4                            |   |
| 10                  | Puffer gewölbt<br>Buffer vaulted  | 88582               | 4                            |   |
| 11                  | Achse 2,6x9,3mm<br>Axle 2,6x9,3mm   | 89700               | 4                            |   |
| 12                  | Achse 2,6x11,5mm<br>Axle 2,6x11,5mm   | 89701               | 3                            |   |
| 13                  | TS - Dach lackiert<br>Part set roof coated                                  | 122559              | 9                            |   |
| 14                  | Lager für Schneckenachse<br>Worm axle bearing                               | 89749               | 6                            |   |
| 15                  | Radsatz m. Zahnrad o. Hafring<br>Wheelset with gear without traction tires  | 90378               | 11                           |   |
| 16                  | Schneckendeckel<br>Worm cover   | 94148               | 6                            |   |
| 17                  | Achslager 1<br>Axlebearing 1  | 94149               | 5                            |   |
| 18                  | Achslager 2<br>Axlebearing 2  | 94150               | 5                            |   |
| 19                  | Achslager 3<br>Axlebearing 3  | 94151               | 5                            |   |
| 20                  | Achslager 4<br>Axlebearing 4  | 94152               | 5                            |   |
| 21                  | Kupplungsdeichsel<br>Holder for coupling                                    | 94154               | 5                            |   |
| 22                  | Blechwinkel<br>Plate angle  | 94155               | 9                            |   |
| 23                  | Innenlichtleiter 1<br>Interior light conductor 1                            | 94160               | 5                            |   |
| 24                  | Innenlichtleiter 2<br>Interior light conductor 2                            | 94161               | 5                            |   |
| 25                  | Stirnlichtlinse D=2<br>Front light lens D=2                                 | 94176               | 3                            |   |
| 26                  | Seitenfenster<br>Side window  | 94173               | 8                            |   |
| 27                  | Lichtleiterträger<br>Light conductor carrier                                | 94167               | 6                            |   |
| 28                  | Stirnfenster mit Wischer<br>Front window with wiper                         | 94158               | 7                            |   |
| 29                  | Brückenstecker<br>Bridge connector  | 100644              | 6                            |   |
| 30                  | Drahtlampe T3/4 16V 30mA<br>Bulb with leds T3/4 16V 30mA                    | 108616              | 8                            |   |
| 31                  | Motorblende<br>Motor frame  | 108757              | 5                            |   |
| 32                  | Lichtleiter<br>Light transmission   | 108766              | 5                            |   |
| 33                  | Modulhalter<br>Modul holder   | 108771              | 6                            |   |
| 34                  | Hülseenteil<br>Sleeve part  | 109134              | 3                            |   |
| 35                  | Platine mitte<br>Printed middle circuit                                     | 109135              | 13                           |   |
| 36                  | Drahtlampe T1 16V/30mA<br>Bulb with leds T1 16 V/30mA                       | 109321              | 8                            |   |
| 37                  | Achszahnrad mit Zahnradachse<br>Gear set                                    | 112673              | 5                            |   |
| 38                  | Getriebedeckel<br>Gear cover  | 112963              | 6                            |   |
| 39                  | Platine unten<br>Printed circuit below                                      | 147551              | 17                           |   |
| 40                  | Platine oben<br>Printed circuit above                                       | 112969              | 14                           |   |
| 41                  | Anlaufscheibe<br>Washer   | 113942              | 3                            |   |
| 42                  | GF-Schraube M 2x4 mm<br>GF-Screw  | 114877              | 3                            |   |
| 43                  | GF-Schraube M2X5 mm<br>GF-Screw   | 114966              | 3                            |   |
| 44                  | Schraube M2X6 mm<br>Screw   | 85682               | 3                            |   |
| 45                  | Bodenplatte<br>Base plate   | 112965              | 16                           |   |
| 46                  | Motor komplett<br>Motor assembly  | 85069               | 28                           |   |
| 47                  | Inneneinrichtung<br>Interiors fittings                                      | 132429              | 11                           |   |
| 48                  | Stirnlinse D=2 kurz<br>Front lens D=2 short                                 | 108765              | 4                            |   |
| 49                  | Dach kpl.<br>Roof ass.  | 94142               | 13                           |   |
| 50                  | E-Lokführer<br>Loco driver  | 110407              | 6                            |   |
| 51                  | Schnecke<br>Wormgear  | 86704               | 6                            |   |
| <b>Sound</b>        |   |                     |                              |   |
| 52                  | Doppelseitiges Klebeband<br>Doublesided adhesive tape                       | 112629              | 3                            |   |
| 53                  | Lautsprecher<br>Loudspeaker   | 129524              | 13                           |   |
| 54                  | Sounddecoder<br>Sounddecoder  | 129800              | 39                           |   |
| 55                  | Lautsprecherhalter<br>Loudspeaker holder                                    | 131214              | 5                            |   |

Änderungen in Konstruktion und Ausführung vorbehalten  
We reserve the right to change the construction and specification

35 o. Abb. / no ill.  
Lichtwechseldecoder  
Light variation decoder

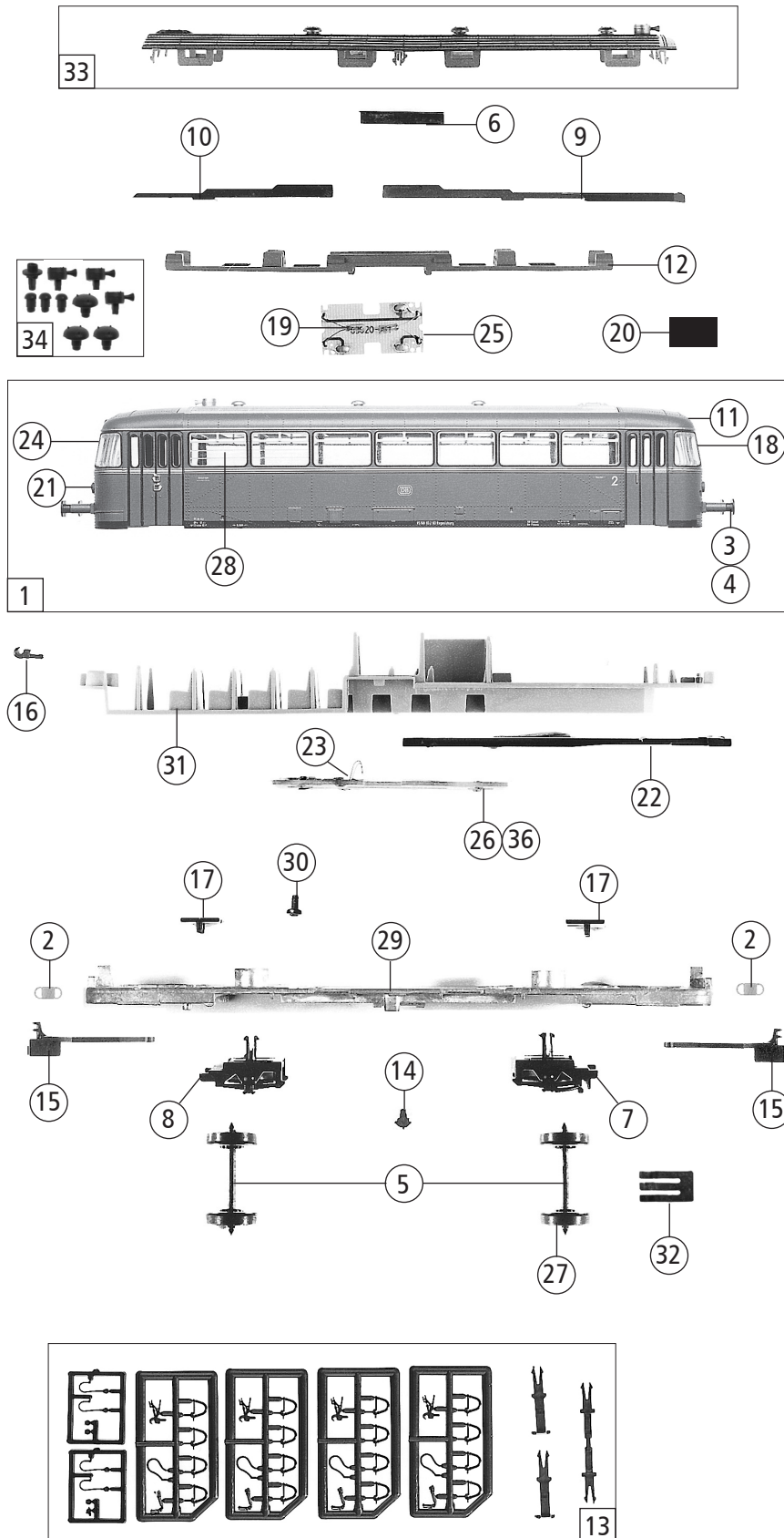

| 52634               |  | DB Schienenbus      | =                            |   |
|---------------------|--|---------------------|------------------------------|---|
| 52635               |  |                     | =                            | 🔊 |
| Pos. Nr.<br>Pos.no. | Beschreibung<br>Description  | Art.-Nr.<br>Art.no. | Preisgruppe<br>Price bracket |   |
| 1                   | Gehäuse komplett für VS Betr.nr. 998 831-2<br>Body assembly Loco no. 998 831-2 | 147553              | 32                           |   |
| 2                   | Zugfeder<br>Tensile spring   | 86208               | 3                            |   |
| 3                   | Puffer flach<br>Buffer flat  | 88581               | 4                            |   |
| 4                   | Puffer gewölbt<br>Buffer vaulted   | 88582               | 4                            |   |
| 5                   | Radsatz ohne Zahnrad VS<br>Wheelset without gear, driving trailer              | 90379               | 9                            |   |
| 6                   | Blechwinkel<br>Plate angle   | 94155               | 9                            |   |
| 7                   | Achslager<br>Axlebearing driving trailer                                       | 94157               | 9                            |   |
| 8                   | Achslager mit Kontakt hinten<br>Axle bearing with contact f. driving trailer   | 112966              | 9                            |   |
| 9                   | Innenlichtleiter 1<br>Interior light conductor 1                               | 94160               | 5                            |   |
| 10                  | Innenlichtleiter 2<br>Interior light conductor 2                               | 94161               | 5                            |   |
| 11                  | Stirnlichtlinse D=2<br>Front light lens D=2                                    | 94176               | 3                            |   |
| 12                  | Träger<br>Girder   | 94167               | 6                            |   |
| 13                  | Zurüstbeutel<br>Bag with accessories   | 94170               | 13                           |   |
| 14                  | WC-Abflußrohr<br>Drainpipe   | 94179               | 4                            |   |
| 15                  | Kupplungsdeichsel<br>Coupling shaft  | 94180               | 5                            |   |
| 16                  | Sicherungshaken<br>Locking hook  | 94184               | 3                            |   |
| 17                  | Deichselniederhalter<br>Holder for towing bar                                  | 94187               | 5                            |   |
| 18                  | Stirnfenster mit Wischer<br>Front window with wiper                            | 94158               | 7                            |   |
| 19                  | Drahtlampe T3/4 16V 30mA<br>Bulb with leds T3/4 16V 30mA                       | 108616              | 8                            |   |
| 20                  | TS - Etikette<br>Part set label  | 125283              | 5                            |   |
| 21                  | Stirnlinse D=2 kurz<br>Front lens D=2 short                                    | 108765              | 4                            |   |
| 22                  | Lichtleiter<br>Light transmission  | 108766              | 5                            |   |
| 23                  | Drahtlampe 16V<br>Bulb with leads 16V  | 111590              | 8                            |   |
| 24                  | Stirnfenster ohne Wischer<br>Front glazing without wiper                       | 94159               | 7                            |   |
| 25                  | Platine oben<br>Printed circuit above, driving trailer                         | 112969              | 14                           |   |
| 26                  | Platine unten<br>Printed circuit below   | 112971              | 20                           |   |
| 27                  | Radsatz für Umschalter<br>Wheelset for switch driving trailer                  | 112999              | 9                            |   |
| 28                  | Seitenfenster<br>Side window driving trailer                                   | 94174               | 8                            |   |
| 29                  | Bodenplatte für Steuerwagen<br>Base plate for driving trailer                  | 113002              | 16                           |   |
| 30                  | Schraube M1,6x3 mm<br>Screw  | 85658               | 3                            |   |
| 31                  | Inneneinrichtung<br>Interior fittings  | 132431              | 10                           |   |
| 32                  | Kontakt ohne Loch<br>Contact w/o hole  | 89984               | 4                            |   |
| 33                  | Dach kpl. Steuerwagen<br>Roof ass. driving coach                               | 94137               | 13                           |   |
| 34                  | TS - Dach lackiert<br>Part set roof coated                                     | 122559              | 9                            |   |
| <b>Sound</b>        |  |                     |                              |   |
| 35                  | Lichtwechseldecoder o. Abb.<br>Light variation decoder no ill.                 | 112967              | 22                           |   |
| 36                  | Platine unten<br>Printed circuit below   | 112970              | 20                           |   |